

**KOGA**<sup>®</sup>

# INSTRUCTION MANUAL

## Specials



©2008 Koga-Miyata B.V.

No part of this publication may be reproduced, transmitted, transcribed, stored in any retrieval system or translated into any human or computer language by any means or in any form, without the prior written permission of Koga-Miyata. Contravention of the owner's copyright may also reduce the ability of Koga-Miyata to provide effective support for its equipment. All the technical information, data and instructions contained in these operating instructions for operations that can and are to be performed, are up to date at the time of editing. They contain our current knowledge and experience to the best of our understanding. We reserve the right to make technical modifications arising from the further development of the range of the product presented in this manual. For this reason, no claims may be derived from technical data, descriptions and illustrations.

Koga-Miyata reserves the right to make changes without notice to both this manual and to its products described within this manual. Nothing in this manual represents any contractual or other commitment on the part of Koga-Miyata and should not be taken as such. All possible care has been taken in the preparation of this publication. Contact Koga-Miyata for suggestions for improvement. This manual was written originally in Dutch. A copy is available on written request.

**KOGA**<sup>®</sup>

## About this Specials book

This Specials book gives you extra information for the Specials bicycles from Koga-Miyata. This Specials book describes only the major parts of the bicycle and the most common settings.

This Specials book is intended as a supplement to the instruction manual. All conditions and actions described in the instruction manual remain in force.

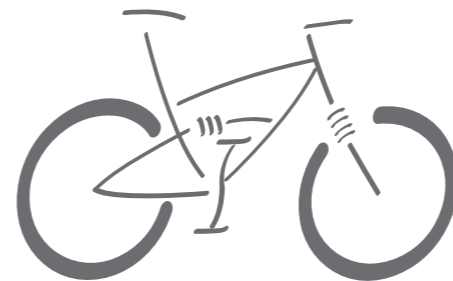

page 6

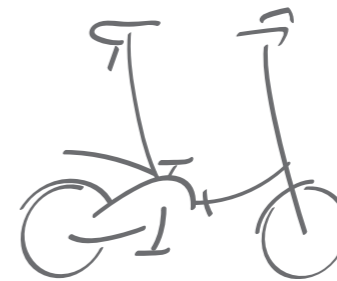

page 8

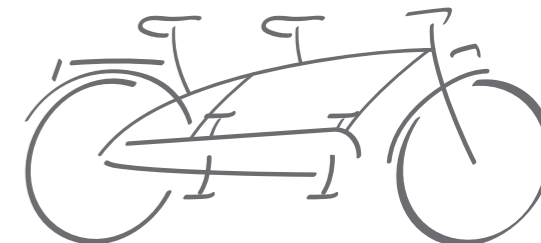

page 10

uk

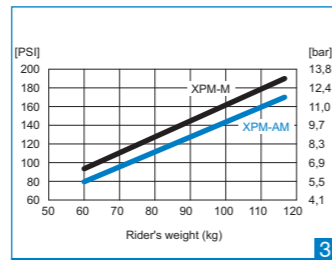
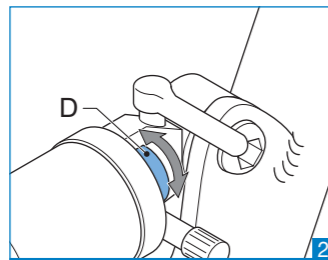
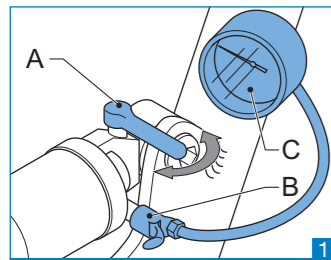

## Mountainbike

### Front suspension fork

The instruction manual for the front suspension fork is supplied standard with the Koga bicycle. Consult the appropriate instruction manual about adjustment and maintenance.

### Rear suspension

#### Xtreme Pivot Management suspension system

The XPM suspension system developed by Koga-Miyata ensures comfort in typical off-road conditions. The XPM suspension system is a unique, progressive damping system.

The progressiveness prevents damage to the rear damper, and minimizes the influence of the pedal stroke.

#### Lock-out

The rear damper can be disconnected by means of the lock-out (1A) if the bicycle is to be used on fast and smooth ground.

#### Rebound control

The rebound control (2D) can be used to adjust the speed with which the suspension system rebounds after compressing. This offers optimum operation of the XPM suspension system under all conditions.

## Adjustment

1. Attach the special pump to the damper (1B).



The pump is not supplied standard with the bicycle. Consult your Koga dealer about this.

2. Bring the damper up to the pressure that corresponds with the weight of the rider (3).



The Koga-Miyata XPM-M and XPM-AM have different pressures. Check which line (3) applies to your Koga bicycle.

3. You can read the pressure in the damper on the indicator of the pump (1C).

## Maintenance

Keep the damper clean.



Regularly check the air pressure of the damper.



Repairs to and maintenance of suspension elements require experience and special tools. Leave this job up to your Koga dealer.

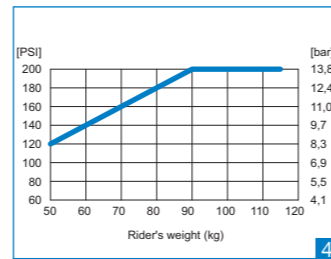
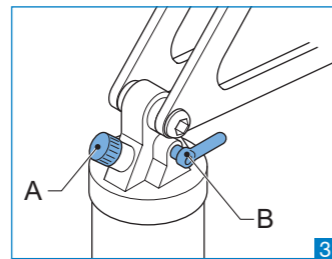
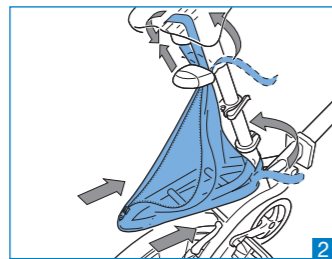
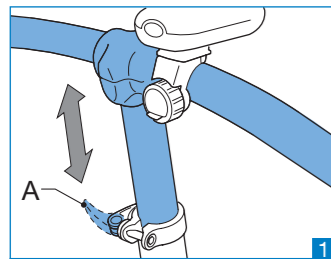

## Founder



The maximum carrying capacity of the Founder is 110 kg.

## Setting the handlebar height

1. Open the quick release (1A).
2. Adjust the handlebar to the desired height.



Never move the handlebar further than the safety marks on the stem.

3. Close the quick release (1A).

## Luggage bag

Mounting the luggage bag:

1. Open the luggage bag.
2. Put the luggage bag over the back carrier.
3. Attach both Velcro strips of the luggage bag around the seat post.
4. Pull the belt through the seat post and close the belt buckle.

## Koga ASL damper

1. Take place on your Koga bicycle as normal with full weight on the saddle.
2. The spring travel of the damper may be no more than 6 mm.

If the spring travel is more than 6 mm, use the pump supplied to increase the air pressure in the damper (3A).

## Lock-out (optional)

The rear damper can be disconnected by means of the lock-out (1A) if the bicycle is to be used on fast and smooth ground.



Minimum air pressure is 120 psi (8 bar) and maximum 200 psi (13 bar).

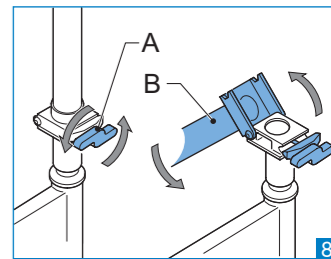
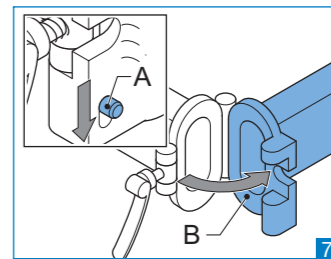
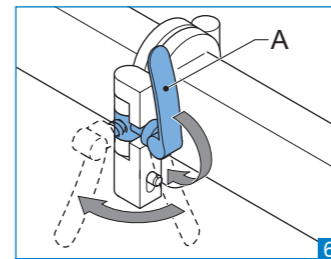
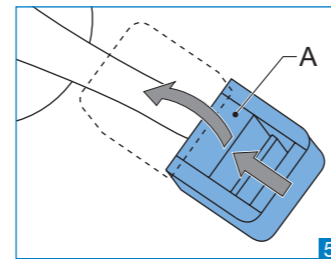

## Folding the Founder

1. Put the bicycle on its stand.
2. Fold the pedals in (5A).
3. Fold the lever (6A) down.
4. Turn the lever (6A) outwards.
5. Push the safety pin (7A) down and fold the frame totally open (7B).
6. Loosen the button (8A).
7. Fold the stem downwards (8B).
8. Fold the lever (9A) open.
9. Push the saddle down as far as possible.
10. Close the lever (9A).
11. The Founder is ready for transport (10).

## Unfolding the Founder

1. Fold the lever (9A) open.
2. Pull the saddle upwards.
3. Make sure the mark on the seat post is not visible.
4. Close the lever (9A).
5. Fold the stem (8B) open.
6. Tighten the button (8A).
7. Fold the Founder out fully until the safety pin (7A) clicks fast.
8. Turn the lever (6A) 90° inwards.
9. Fold the lever (6A) fully down.
10. Fold the pedals out (5A).

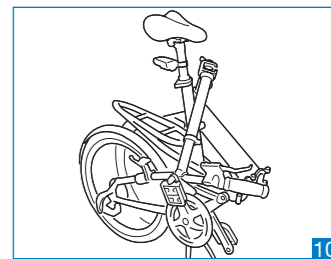
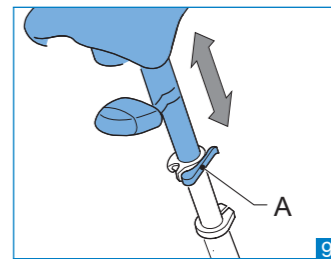

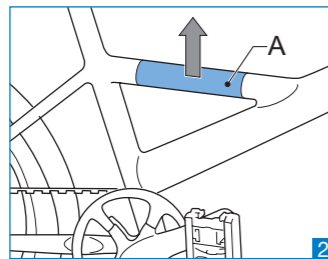
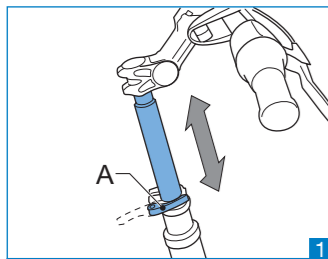

### Adaptor



The overall weight of bike, rider and luggage may not exceed 120 kg.

### Handlebar height adjustment

1. Open the quick-release (as pictured).
2. Move the handlebars to the required height.



When adjusting the handlebar height, ensure that the handlebar do not turn, and that it is not pulled out beyond the minimum insertion mark on the stem.

3. Close the quick-release.

### Carrying the Adaptor

The Adaptor can easily be lifted and carried by the short top tube (as pictured).

### Maintenance of the toothed belt drive

Clear off rough dirt regularly, particularly from the toothed side of the belt.

Do not lubricate the belt.



The working life and proper functioning of the belt can be affected by:

- twisting
- folding, kinking or rolling up
- Turning inside out
- Knotting
- Excessive dirt
- Objects coming between the teeth of the drive belt (pebbles, twigs etc.)

### Replacement of the toothed belt

With normal use and regular cleaning, the toothed belt has a long working life. We recommend that if it is ever necessary, belt replacement is carried out only by a Selected Koga Dealer.

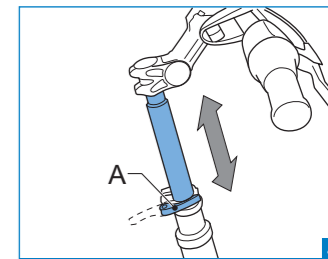
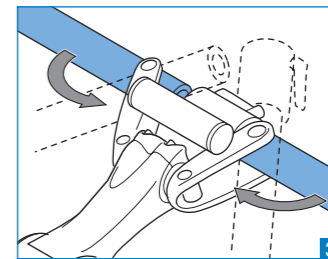
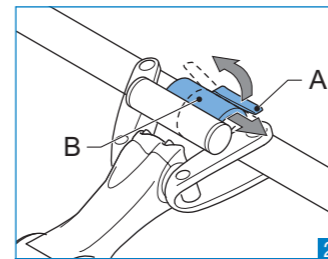
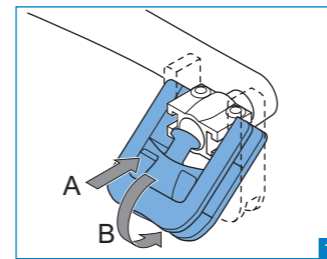

### Folding the Adaptor



When folding and unfolding, or when adjusting handlebar or saddle heights, ensure that the stem and seatpost do not turn, and that they are not pulled out beyond their minimum insertion marks.

1. Set the bike on its stand.
2. Fold the pedals (picture 1).
3. Open the lever on the handlebars and press the spring closure to the left, until the right-hand section of the bars comes free (picture 2).
4. Fold the both handlebar sections backwards 90

degrees (3).

5. Open the lever on the stem (picture 4).
6. Push the stem down as far as it will go.
7. Close the lever.
8. Open the lever on the seatpost (picture 5).
9. Push the seatpost down.
10. Close the lever.
11. The Adaptor is now folded and ready for transport (picture 6).

### Unfolding the Adaptor

1. Set the bike on its stand.
2. Open the lever on the seatpost (picture 5).
3. Pull the saddle up to your required height.
4. Close the lever.

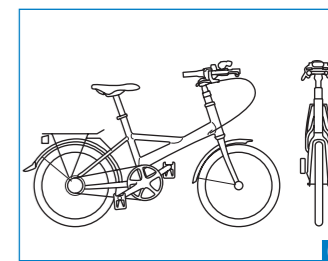
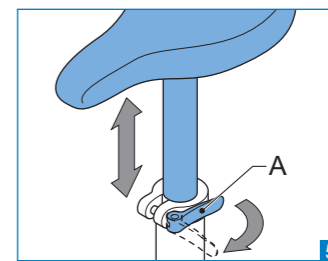

5. Open the lever on the stem (picture 4).
6. Pull the stem up to your required height.
7. Close the lever.
8. Open the lever on the handlebars and fold the right-hand handlebar section 90 degrees forwards (picture 3).
9. Pull the spring closure to the

- right, and fold the left-hand handlebar section 90 degrees forwards. (2 and 3)
10. Let the spring closure go, so that it can push completely over the left-hand half handlebar.
11. Close the lever on the handlebars.
12. Unfold both pedals (picture 1).
13. The Adaptor is ready to ride.

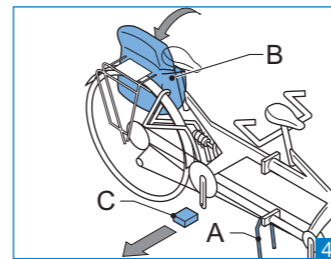
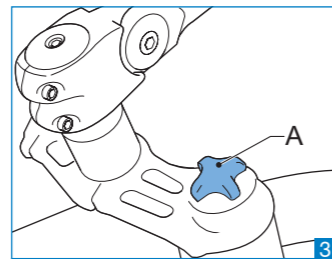
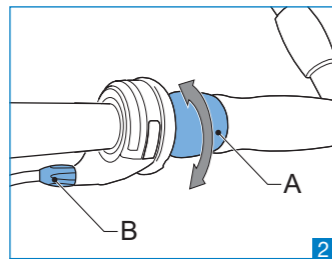
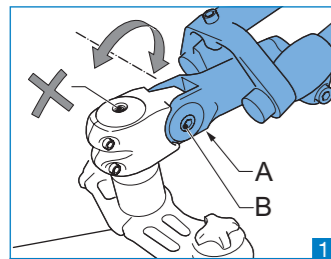

## TwinTraveller



The maximum carrying capacity of the TwinTraveller is 250 kg.

### Setting the handlebar height

1. Loosen the screws (1A and 1B).
2. Adjust the handlebar to the desired height.
3. Tighten the screws (1A and 1B).

## Band brake

The band brake can be operated by the rear cyclist.

1. Turn the Gripshift switch (2A) to activate the band brake.
2. Use the band brake during descents to avoid high speeds.



After the band brake has been used, the disc brake can be extremely hot.

## Braking power of the band brake

Wear can make the band brake lose its braking power.

1. Turn the adjustment button (2B) to adjust the braking power.

## Koga Downhill front fork



Before use, adjust the front fork to the intended use and the weight of the total load.

## Rear suspension



Never disassemble the spring element: it is under high pressure. Leave maintenance up to your Koga dealer.

## Folding the TwinTraveller

1. Put the bicycle on its stand (4A).
2. Attach the bag to the left side of the back carrier (4B).
3. Disassemble the pedals (4A) and put them in the bag (4B).

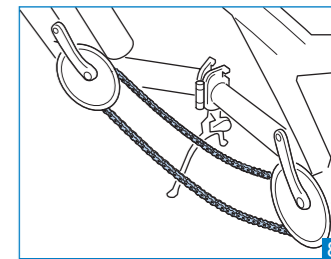
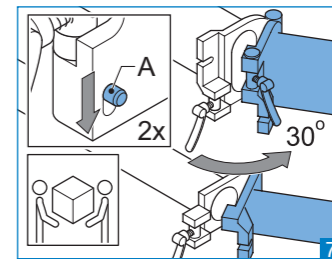
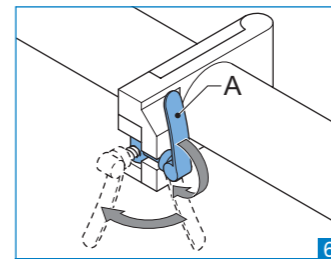
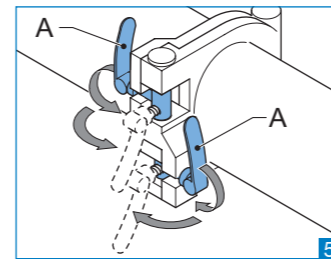

4. Fold the levers down (5 and 6).
5. Turn the levers 90° outwards (5 and 6).

6. Push the two safety pins (7A) downwards.



The frame's own weight makes it fold slightly.

7. Fold the frame 30° open (7).



Check that the bicycle remains sufficiently in balance if you let go of it.

8. The front chain comes loose (8).

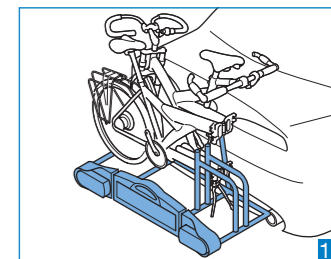
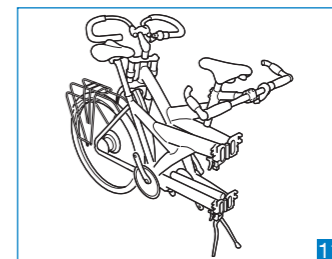
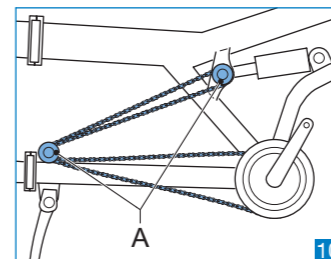
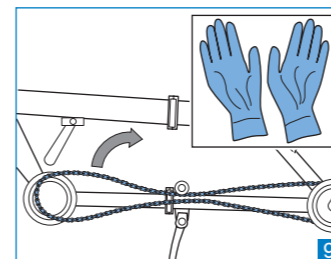

9. Pull on the gloves supplied.
10. Take the chain off the front chain ring (9).

11. Mount the chain via the rollers (10A).
12. Use the quick release to tension the chain on the lower roller.

13. Fold the TwinTraveller fully (11).

14. The TwinTraveller can be transported by car on the Uebler bicycle carrier (12). Follow the instructions in the manual supplied.

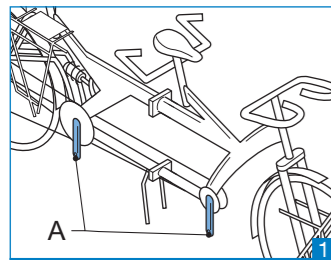

## Unfolding the TwinTraveller

Unfolding the TwinTraveller is done in the opposite order to folding it.

1. Fold the TwinTraveller open to 30°.
2. Pull on the gloves supplied.

 Turn both cranks to the same position (1A).

4. Fold the lever open.
5. Remove the chain from both rollers.
6. Mount the chain on the front chain ring.

7. Unfold the TwinTraveller fully until the two safety pins click fast.
8. Turn the levers 90° inwards.
9. Fold the levers fully down.
10. Mount the pedals.
11. The TwinTraveller is ready for use.

## Guarantee conditions for Koga bicycles

### Article 1 Guarantee

- 1.1 Koga provides a guarantee only to the first owner of the bicycle in question; the second or following owner can only call in the party from whom the bicycle was purchased in the event of damage.
- 1.2 Guarantee lapses in accordance with the provisions of articles 3.1 and 5.1.
- 1.3 The guarantee cannot be transferred.

### Article 2 Guarantee period

- 2.1 Every Koga bicycle has a limited life, the so-called useable life cycle. The duration of the useable life cycle of bicycles depends on the type of frame, the way in which and the circumstances under which the bicycle is ridden and the care/maintenance the bicycle receives. The duration of the useable life cycle is not equal to the duration of the lifetime guarantee period. The lifetime guarantee period is established on the basis of the duration of the useable life cycle of the bicycle. This cycle depends to a great extent on various factors; these factors are stated in article 2.5. Koga sets this cycle at an average of 25 years. Koga-Miyata frames and non-suspension front forks have a lifetime guarantee on the absence of construction and/or material defects, this guarantee applying to all aluminium, Scandium and chrome-molybdenum frames and non-suspension front forks. A guarantee period of 3 years applies to Carbon and/or suspension frames. For frames and non-suspension front forks of racing bicycles and mountain bikes used for professional or semi-professional competitive use, a guarantee period of 2 years applies to the absence of construction and/or material defects. The above-mentioned

guarantee periods apply to models from the model year 2007 onwards.

- 2.2 For front suspension forks, dampers and all other parts, except for the parts mentioned in paragraphs 1 and 4 of this article, there is a guarantee on the absence of construction and/or material defects for a period of 2 years.
- 2.3 For paintwork of frame and non-suspension front forks there is a guarantee period of 10 years for the absence of corrosion and oxidization from the inside, if the bicycle is well maintained. For other paintwork and chrome parts there is a guarantee period of 2 years for the absence of corrosion and oxidization from the inside, if the bicycle is well maintained.
- 2.4 No guarantee is given for parts subject to wear, such as tyres, chain, chain rings, back gear rings, cables and brake blocks, unless there is a question of construction and/or material defects.
- 2.5 Among other things, the following factors or a combination of these factors can influence the useable life cycle of a bicycle: use of the bicycle for competitions and intensive training, use of the bicycle for purposes for which it was not designed, excessive weight, riding in all weather conditions or different climates, geographical circumstances. Koga recommends all Koga bicycles be checked regularly by a recognized Koga-Miyata dealer for signs of potential problems such as corrosion, break, deformation and improper use. These preventative checks are important for preventing accidents and injuries. In principle, service checks are not free of charge.

### Article 3 Guarantee exclusions

- 3.1 The guarantee lapses in the following cases:
  - a. Improper and/or careless use of the bicycle and use that does not correspond with its intended use;
  - b. The bicycle has not been maintained in accordance with the user manual;
  - c. Technical repairs have not been performed in a competent manner;
  - d. Parts mounted at a later date do not correspond with the technical specification of the bicycle in question or have been mounted incorrectly;
  - e. The bicycle is used for hire or made available to more than one unspecified person in other ways.
- 3.2 Furthermore, Koga B.V. expressly disclaims any responsibility for damage to (parts of) the bicycle as a result of:
  - a. Incorrect adjustment/tensioning of the handlebar, saddle, seat post, derailleur set, brakes, quick release of the derailleur set, brakes, quick release of the wheels and tyres;
  - b. Not replacing parts in time such as brake or derailleur cables, brake blocks, tyres, chain and gear wheels;
  - c. Climatological influences such as normal weathering of paint or chrome rust.

### Article 4 Guarantee parts

- 4.1 During the guarantee period, all parts for which Koga B.V. has established that there is a question of material and/or construction defect, will be repaired or reimbursed at the discretion of Koga B.V.
- 4.2 Any expenses of mounting or disassembly are at the expense of the owner.
- 4.3 Contrary to the provisions of the previous paragraph, for frames and front forks the labour wages are at the expense of the manufacturer

during three years after the date of purchase. 4.3.1 Costs of transport of the bicycle and/or parts from and to Koga B.V. are at the expense of the owner.

4.3.2 If a certain part qualifies for guarantee, this part will be replaced by a new part or equivalent part. Koga B.V. cannot, however, guarantee that frame types or colours remain available.

4.4 Parts that no longer fit technically, or are no longer available for the replacement guarantee frame are delivered free of charge in the first three years after the date of purchase. After this period, the replacement parts are charged to the customer.

### Article 5 Submitting a claim

- 5.1 Claims under this guarantee must – with presentation of the bicycle for inspection – be submitted via the Koga dealer from whom the bicycle was purchased. At the same time, the proof of purchase and/or the proof of ownership provided with the bicycle must be handed over to the dealer.
- 5.2 If the owner has moved house or the dealer is no longer available, Koga B.V. will, if requested, provide information about the nearest Koga dealer.

### Article 6 Liability

6.1 A guarantee claim accepted by Koga B.V. does not automatically mean that Koga B.V. also assumes responsibility for any damage suffered. The liability of Koga B.V. is confined to what is set out in these guarantee conditions. Any liability of Koga B.V. for consequential damage is expressly excluded. The provisions of this condition do not apply if and insofar as they arise from mandatory statutory provisions.

SELECTED KOGA DEALER:

KOGA B.V. / KOGA-MIYATA P.O. BOX 167 8440 AD HEERENVEEN THE NETHERLANDS

[www.koga.com](http://www.koga.com)